

## Metal Standard Split Ring Pipe Hanger Clamp

Our Product Introduction

for more products please visit us on [channel-fittings.com](http://channel-fittings.com)

### Basic Information

- Place of Origin: Jiangsu, China
- Brand Name: HENG TONG
- Model Number: PCH-008
- Minimum Order Quantity: 1000 pieces
- Price: \$0.50 - \$3.50/pieces
- Packaging Details: CARTON+PALLET
- Supply Ability: 1000000 Piece/Pieces per Month



### Product Specification

- Material: Metal
- Standard Or Nonstandard: Standard
- Usage: Pipe Clamp
- Structure: Spring Clamp
- Port: Shanghai
- Highlight: Split Ring Pipe Hanger, Pipe Hanger Split Ring, Pipe Hanger

PCH型标准管夹  
PCH-Type Pipe Ring, standard duty

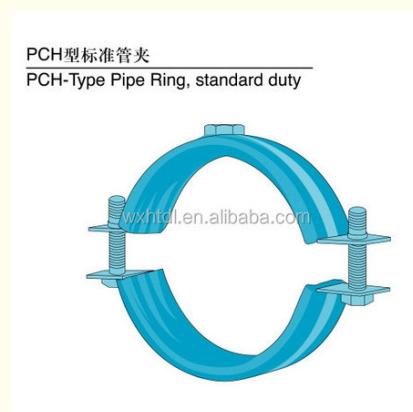

### More Images



## Product Description

### Split Ring Pipe Hanger

They offer compatibility with various types of insulation materials, allowing for the installation of insulated pipe systems.

These clamps can be employed in the construction of scaffolding and temporary structures, providing support for pipes and conduits.

Pipe clamps provide stability and support for the installation of hydronic heating systems, such as radiant floor heating.

Pipe clamp is applied in the areas of pipeline systems. E.g.: sanitary and heating installations, gas distribution systems, air conditioning systems, etc..

— PCH型标准管夹 PCH-Type Pipe Ring, Standard duty

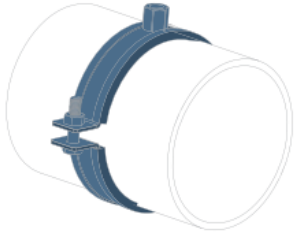

#### 技术参数:

卡箍材质: 低碳钢  
表面处理: 电镀锌  
衬套材质: 惰性橡胶

#### Specification:

Clamp Material: Low Carbon Steel  
Finish: Electro Galvanizing  
Inlay Material: EPDM Rubber

重型管夹可以定制  
Heavy duty series are available

| 管束编号<br>Part No. | 管径范围 (mm)<br>Size Range | 吊杆<br>Rod | 材料尺寸 (mm)<br>Size of Steel | 螺栓<br>Bolt | 设计荷载 (KN)<br>Design Load |
|------------------|-------------------------|-----------|----------------------------|------------|--------------------------|
| PCH-006          | 8-11                    | M8/M10    | 1.5*20                     | M6         | 1.0                      |
| PCH-008          | 12-16                   | M8/M10    | 1.5*20                     | M6         | 1.0                      |
| PCH-010          | 17-20                   | M8/M10    | 1.5*20                     | M6         | 1.0                      |
| PCH-015          | 21-24                   | M8/M10    | 1.5*20                     | M6         | 1.0                      |
| PCH-020          | 25-28                   | M8/M10    | 1.5*20                     | M6         | 1.0                      |
| PCH-025A         | 29-32                   | M8/M10    | 1.5*20                     | M6         | 1.0                      |
| PCH-025          | 33-37                   | M8/M10    | 1.5*20                     | M6         | 1.0                      |
| PCH-032A         | 38-41                   | M8/M10    | 1.5*20                     | M6         | 1.0                      |
| PCH-032          | 42-46                   | M8/M10    | 1.5*20                     | M6         | 1.0                      |
| PCH-040          | 47-51                   | M8/M10    | 1.5*20                     | M6         | 1.0                      |
| PCH-050A         | 52-56                   | M8/M10    | 1.5*20                     | M6         | 1.0                      |
| PCH-050          | 57-61                   | M8/M10    | 1.5*20                     | M6         | 1.0                      |
| PCH-065B         | 62-66                   | M8/M10    | 2.0*25                     | M6         | 1.2                      |
| PCH-065A         | 67-71                   | M8/M10    | 2.0*25                     | M6         | 1.2                      |
| PCH-065          | 72-77                   | M8/M10    | 2.0*25                     | M6         | 1.2                      |
| PCH-080A         | 78-84                   | M8/M10    | 2.0*25                     | M6         | 1.2                      |
| PCH-080          | 87-93                   | M8/M10    | 2.0*25                     | M6         | 1.2                      |
| PCH-090          | 99-104                  | M10/M12   | 2.5*25                     | M8         | 2.5                      |
| PCH-100A         | 108-112                 | M10/M12   | 2.5*25                     | M8         | 2.5                      |
| PCH-100          | 114-118                 | M10/M12   | 2.5*25                     | M8         | 2.5                      |
| PCH-125B         | 123-128                 | M10/M12   | 2.5*25                     | M8         | 2.5                      |
| PCH-125A         | 131-137                 | M10/M12   | 2.5*25                     | M8         | 2.5                      |
| PCH-125          | 138-144                 | M10/M12   | 2.5*25                     | M8         | 2.5                      |
| PCH-150A         | 157-163                 | M10/M12   | 2.5*25                     | M8         | 2.5                      |
| PCH-150          | 164-170                 | M10/M12   | 2.5*25                     | M8         | 2.5                      |
| PCH-200          | 216-220                 | M10/M12   | 2.5*25                     | M8         | 2.5                      |

#### Feature :

- 1) Bigger adjusting range
- 2) Evenly stress when fastening
- 3) Wrest resistant and high crushing strength
- 6) sizes: by customers' requirements
- 7) high quality and competitive price
- 8) It has different bandwidths as per the different sizes.
- 9) The band thickness is also different for different bandwidths









 **Wuxi Hengtong Metal Framing System Co., Ltd.**

 +86 15251535252  [elinglu@htstrut.com](mailto:elinglu@htstrut.com)  [channel-fittings.com](http://channel-fittings.com)

No 6 East Dingxiang Road Hudai Industry Zone Wuxi City 214161 China